

INDUSCITY GWADER

LAND USED IN PERCENTAGE

PARKS = 16950.0 SYDS 7.0%
 G.D.A = 4840.0 SYDS 2.0%
 GRAVEYARD = 4840.0 SYDS 2.0%
 MASID, HOSPITAL = 666.6 SYDS 0.3%
 SCHOOLS etc = 4949.6 SYDS 2.0%
 TOTAL = 31579.6 SYDS 13.0%

LEGEND

TOTAL AREA OF COMMERCIAL = 9600.0 SYDS 3.97%
 TOTAL AREA OF RESIDENTIAL = 115832.0 SYDS 47.86%
 TOTAL AREA OF AMENITIES = 31579.6 SYDS 13.0%
 TOTAL = 157011.6 SYDS 64.8%
 ROAD = 84988.4 SYDS 35.2%

RESIDENTIAL

HILLOCK - I
 1 TO 204 261 NOs = 23279.02 SQ YDS
 1 TO 16 16 NOs = 3293.33 SQ YDS
 1 TO 20 20 NOs = 2094.38 SQ YDS

HILLOCK - II
 1 TO 48 48 NOs = 9609.99 SYDS
 1 TO 180 180 NOs = 16944.40 SYDS

HILLOCK - III
 1 TO 48 48 NOs = 9609.99 SYDS
 1 TO 184 184 NOs = 16944.40 SYDS

HILLOCK - IV
 1 TO 16 16 NOs = 3293.33 SQ YDS
 1 TO 20 20 NOs = 2094.38 SYDS
 1 TO 235 232 NOs = 20624.67 SQ YDS

Total = 116,888.26 SQ YRDS 48.3%

SCHEDULE OF AREA

Total Area of Plots = 217800. SFT
 OR = 242000.0 SQD
 OR = 50.0 ACR

COMMERCIAL

PHASE - II 1 TO 40 NOs = 4000.0 syds
 PHASE - III 1 TO 40 NOs = 4000.0 syds
 PHASE - IV 1 TO 16 NOs = 1600.0 syds
 Total = 9704.10 syds 4 %

AMENITIES

PARK 1 = 4850.0 SYDS
 PARK 2 = 4850.0 SYDS
 PARK 3 = 2250.0 SYDS
 PARK 4 = 950.0 SYDS
 PARK 5 = 1800.0 SYDS
 PARK 6 = 2250.0 SYDS

MASID = 666.6 SYDS
 SCHOOL = 666.6 SYDS
 HOSPITAL = 666.6 SYDS
 MASID DECLINATION PLANT = 666.6 SYDS
 RECYCLE PLANT = 666.6 SYDS
 PUBLIC BUILDING = 666.6 SYDS

TOTAL = 21899.6 syds 9.0%
 G.D.A RESERVED GRAVEYARD = 4840.0 SYDS 2%
 = 4840.0 SYDS 2%

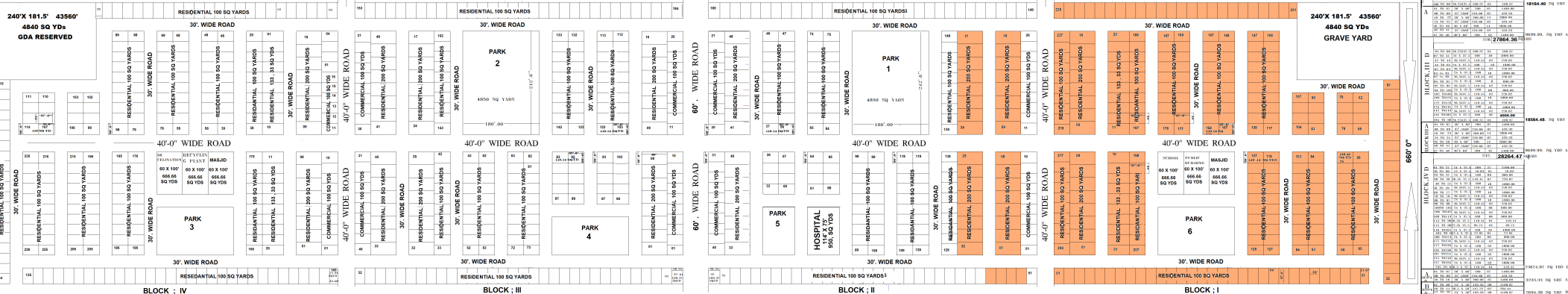

LAY OUT PLAN

3300'

AREA SCHEDULE	
AREA	PROPOSED 50 ACRES (SCHED)
AREA	= 50.00 ACRES
OR	= 242000.00 SQ YRDS
OR	= 517000.00 SQ FT
1	100.00
2	100.00
3	100.00
4	100.00
5	100.00
6	100.00
7	100.00
8	100.00
9	100.00
10	100.00
11	100.00
12	100.00
13	100.00
14	100.00
15	100.00
16	100.00
17	100.00
18	100.00
19	100.00
20	100.00
21	100.00
22	100.00
23	100.00
24	100.00
25	100.00
26	100.00
27	100.00
28	100.00
29	100.00
30	100.00
31	100.00
32	100.00
33	100.00
34	100.00
35	100.00
36	100.00
37	100.00
38	100.00
39	100.00
40	100.00
41	100.00
42	100.00
43	100.00
44	100.00
45	100.00
46	100.00
47	100.00
48	100.00
49	100.00
50	100.00
51	100.00
52	100.00
53	100.00
54	100.00
55	100.00
56	100.00
57	100.00
58	100.00
59	100.00
60	100.00
61	100.00
62	100.00
63	100.00
64	100.00
65	100.00
66	100.00
67	100.00
68	100.00
69	100.00
70	100.00
71	100.00
72	100.00
73	100.00
74	100.00
75	100.00
76	100.00
77	100.00
78	100.00
79	100.00
80	100.00
81	100.00
82	100.00
83	100.00
84	100.00
85	100.00
86	100.00
87	100.00
88	100.00
89	100.00
90	100.00
91	100.00
92	100.00
93	100.00
94	100.00
95	100.00
96	100.00
97	100.00
98	100.00
99	100.00
100	100.00

96 9704.10